



RHINO-RACK

Aerodynamic & Heavy Duty Roof Rack Systems

S400-FK1 RHINO Sportz, RHINO Aero, ROLA Universal Rails Bar.

Place these instructions in the vehicle's glove box after installation is complete.

Important: Please read these instructions carefully prior to installation.
Please refer to your fitting instruction to ensure that the cross bars are installed in the correct locations.
Check the contents of kit before commencing fitment and report any discrepancies.

Parts List

Item	Component Name	Qty.	Part No.
1	M6 Wing Nut	4	N016
2	M6 Spring Washer	4	W004
3	1/4" x 1 1/4" Flat Washer	4	W029
4	Rhino T-bolt Tab	4	M086
5	M6 x 25mm T-bolt	4	B090
6	M6 x 25mm Sq Head Sportz Bolt	4	B015
7	Fitting Instruction	1	RS-272

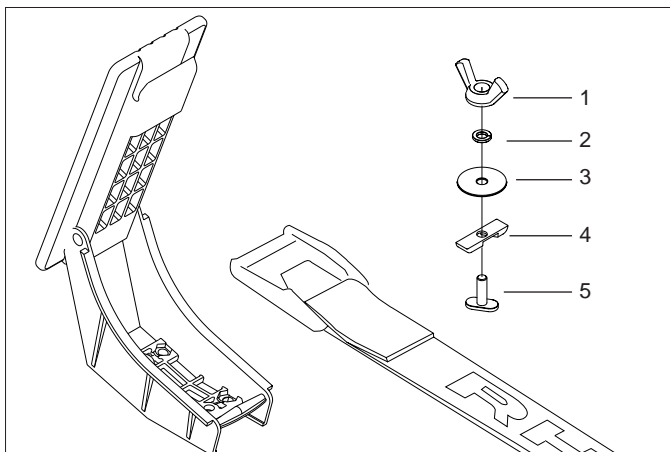

RHINO bars: Insert the M6 T-bolt into the top recess of the cross bar and turn 90 degrees. Assemble the T-bolt tab onto the T-bolt, ensuring that the T-bolt tab locks over the T-bolt flange. The T-bolt tab must be level or below the top surface of the crossbar when assembled.

ROLA bar: Slide the M6 x 25 Sq Head Sportz Bolt in from one end of the cross bar.

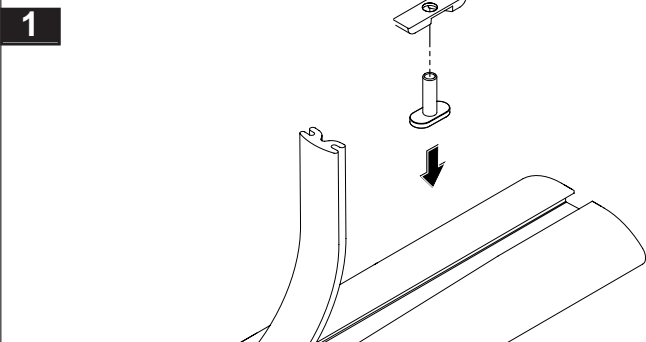

Place the carrier onto the M6 T-bolt through the center mounting hole (front or rear hole). Assemble the flat and spring washers onto the T-bolt.

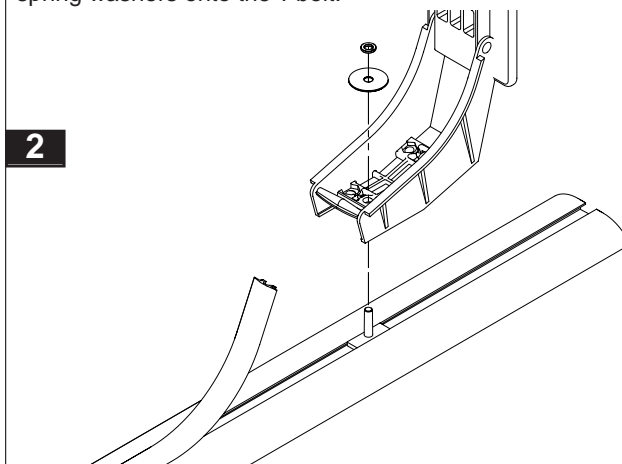

Screw the M6 wing nut onto the T-bolt with 2 turns.

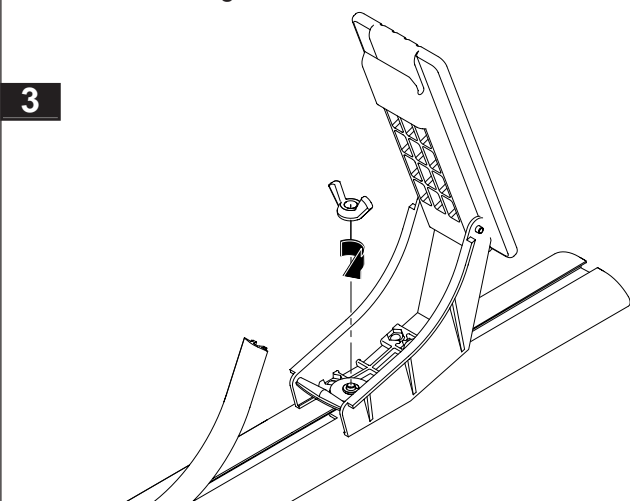

Adjust the carriers to suit the kayak or canoe. Tighten the wing nut to secure the carrier. Cut the rubber buffer strip to suit.

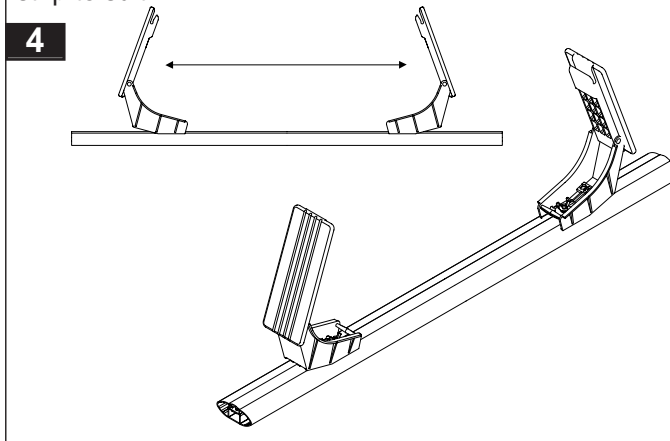

Kayak / Canoe Carrier Loading Instruction

Insert the rubber kayak / canoe support pad cut out into the carrier housing locating bar.

1

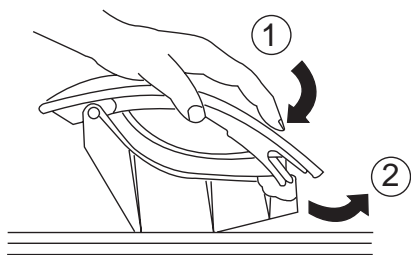

Below are the 2 positions in which the carriers can be fitted to suit various kayak / canoe shapes. When using the tie down straps provided please fasten as shown below. After securing the kayak or canoe, check the load for safety.

2

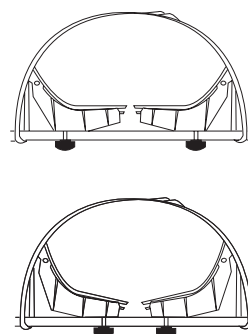

Long Load Instruction

Long loads must be secured front and rear as shown below.

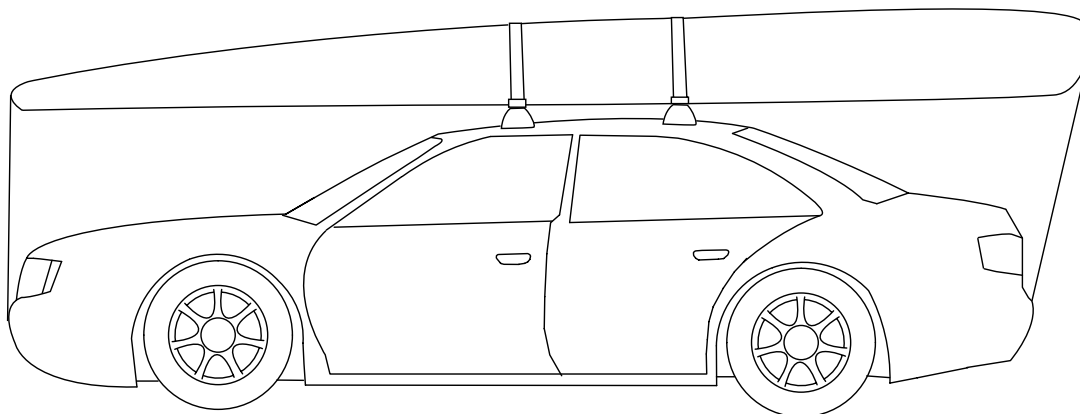

Please Note: The maximum permissible roof load must not be exceeded (see vehicle hand book for details of the maximum roof load).
The roof load comprises the weight of the basic rack plus the additional accessory and load itself.
Check that the rack system is securely fitted before each trip and at regular intervals.

Sensitivity to Cross winds, Behaviour in curves and braking:

The handling of the vehicle changes when transporting a load on the roof. For safety reasons, we recommend you exercise extreme care transporting wind resistant loads.

Rhino-Rack
3 Pike Street, Rydalmere,
NSW 2116, Australia.
(Ph) (02) 9638 4744
(Fax) (02) 9638 4822

Document No: RS-272
Prepared By: Craig Jones
Authorised By: Gary England

Issue No: 02
Issue Date: 18/10/2006

These instructions remain the property of Fetovu Pty Ltd T/as Rhino-Rack and may not be used or changed for any other purpose than intended.