



RHINO-RACK

Aerodynamic & Heavy Duty Roof Rack Systems

RCP19 Nissan X-Trail - Heavy Duty Removable 2 Bar System

Important: Please read these instructions carefully prior to installation.
Please refer to your fitting instruction to ensure that the cross bars are installed in the correct locations.
Check the contents of kit before commencing fitment and report any discrepancies.
Place these instructions in the vehicle's glove box after installation is complete.

Layout

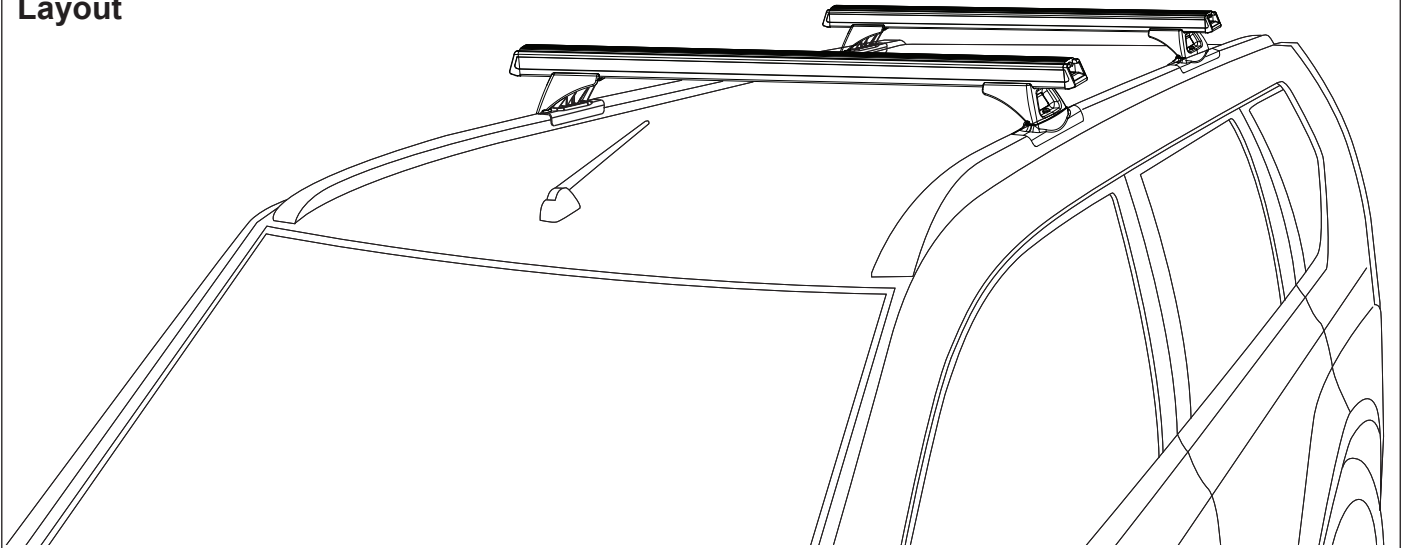

IMPORTANT Care Instruction:

Clean roof mounting area prior to fitting the Heavy Duty Bars.

Important Information

Maximum carrying capacity: 80kg.

Recommendations:

It is essential that all bolt connections be checked after driving a short distance when you first install your cross bars. Bolt connections should be checked again at regular intervals (probably once a week is enough, depending on road conditions, usage, loads and distances travelled). You should also check the cross bars each time they are re-fitted. Make sure to fasten your load securely. Please ensure that all loads are evenly distributed over the two cross bars and that the centre of gravity is kept as low as possible.

Use only non-stretch fastening ropes or straps.

Caution:

The handling characteristics of the vehicle change when you transport a load on the roof. For safety reasons, we recommend exercising extreme care when transporting large wind-resisting loads; special consideration must be taken into account when negotiating corners and under braking.

Please remove cross bars when putting vehicle through an automatic car wash.

Load Ratings:

Maximum permissible load is **80kg evenly distributed over the two cross bars**. When cross bars are to be used in off-road conditions, please build a safety factor of 1.5 into this load limit. **60kg maximum for off-road conditions**. Although the cross bars are tested and approved to AS1235-2000, Australian road conditions can be much more rigorous. Increasing the number of cross bars does not increase the vehicles maximum permissible roof loading.

Note for Dealers and Fitters:

It is your responsibility to ensure instructions are given to the end user or client.

Rhino-Rack
3 Pike Street, Rydalmere,
NSW 2116, Australia.
(Ph) (02) 9638 4744
(Fax) (02) 9638 4822

Document No: RCP19
Prepared By: Andy Wana
Authorised By: Gary England

Issue No: 02
Issue Date: 20/09/2011



RCP19 Nissan X-Trail Heavy Duty Removable 2 Bar System

Parts List

Item	Component Name	Qty.	Part No.
1	Heavy Duty Rubber Buffer 1250mm	2	Sold Separately
2	Heavy Duty Cross Bar 1250mm	2	Sold Separately
3	5mm Security Allen Key	1	H021
4	Heavy Duty Cross Bar End Cap	4	M002
5	M6 x 27mm Security Bolt	12	B063
6	M6 Spring Washer	12	W004
7	M6 x 12.5mm Flat Washer	4	W003
8	RCP Leg	4	M123
9	M6 x 16mm Flat Washer	8	W031
10	M10 Channel Nut	4	N024
11	M10 x 38mm Flat Washer	4	W022
12	M10 Internal Shakeproof Washer	4	W021
13	M10 x 20mm Hex Bolt	4	B003
14	Front Left Pad	1	M383
15	Front Right Pad	1	M384
16	Rear Left Pad	1	M385
17	Rear Right Pad	1	M386
18	Mounting Pad Cover Plates	4	M126
19	Fitting Instruction	1	

Tools Required

- a. Phillips Head Screw Driver c. 5/8 Ring Spanner
b. Flat Head Screw Driver

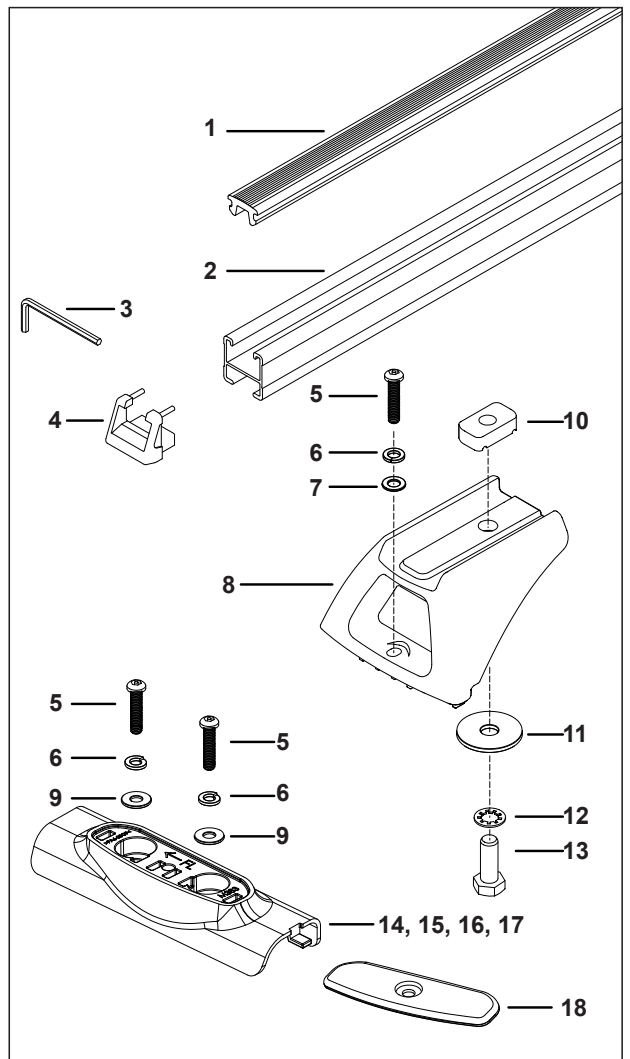
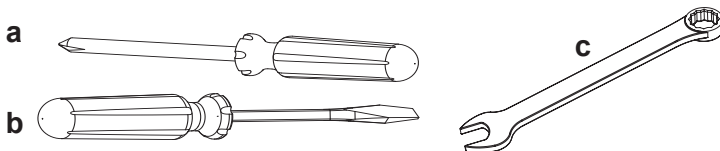

Fitting Instructions

1

Use a suitable Flat Head Screw Driver to remove the four covers in the roof railing. Store in a suitable place.

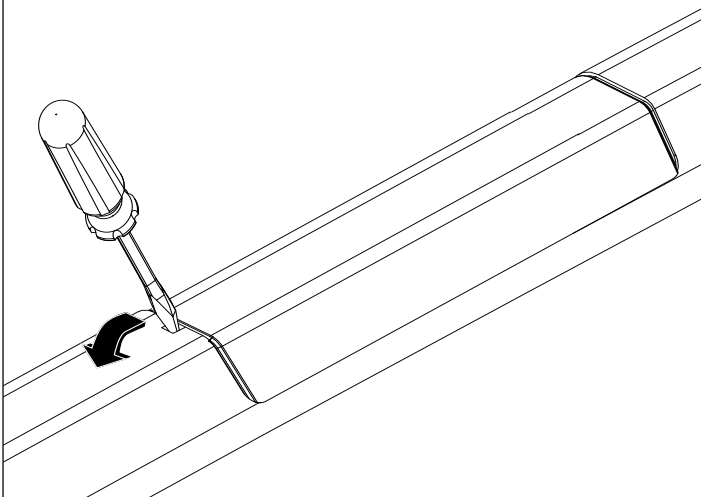

2

Slide the Legs into each end of the Cross Bar. Make sure the Channel Nut locates across the bar as shown. Only finger tighten the M10 Channel Nut bolt at this stage.

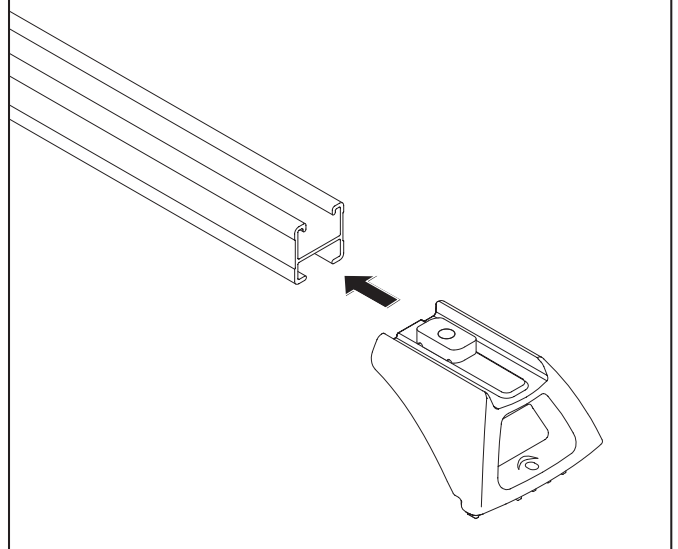



RCP19 Nissan X-Trail Heavy Duty Removable 2 Bar System

3

Finger tighten the Leg attachment bolt so that the Channel Nut turns to locate across the Bar. The legs will require adjustment later.

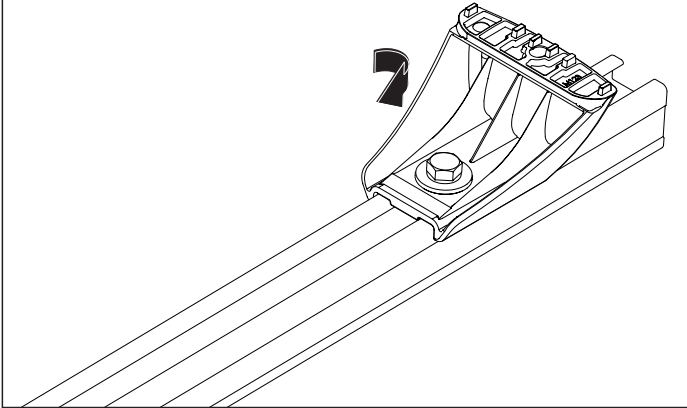

4

It is very important that the Channel Nut is fully located across the Bar as shown.

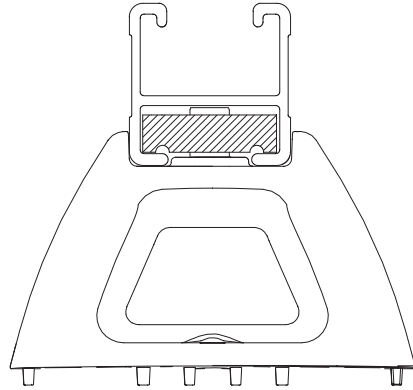

5

Each Pad is identified according to its position on a car. The arrow on each pad always points towards the front of the vehicle.

Each pad is identified as follow:

FL - Front Left

RL - Rear Left

FR - Front Right

RR - Rear Right

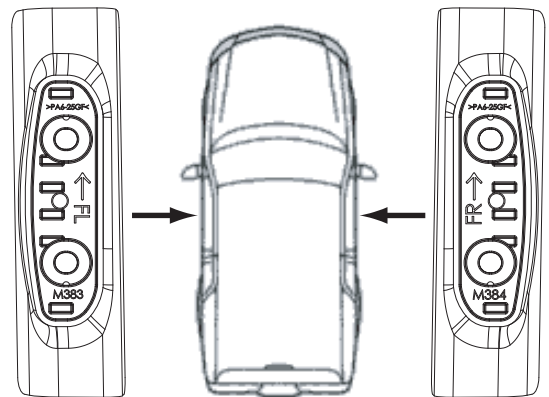

6

Insert the lug on the Pad into the corresponding slot in the rail moulding as shown. (FR pad shown here)

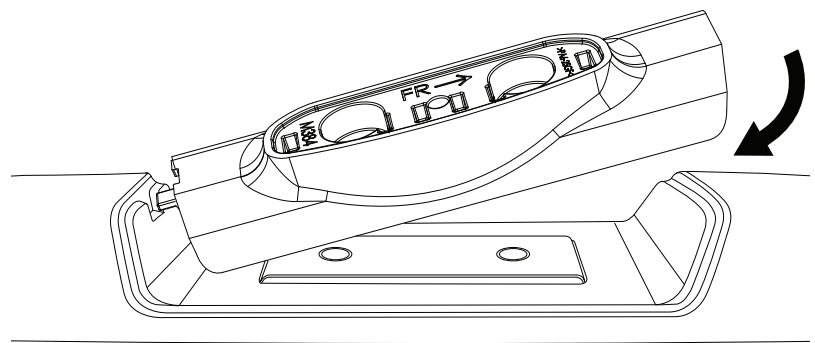

Front of vehicle →

Position the Pad so that it sits flush in relation to the rail moulding.

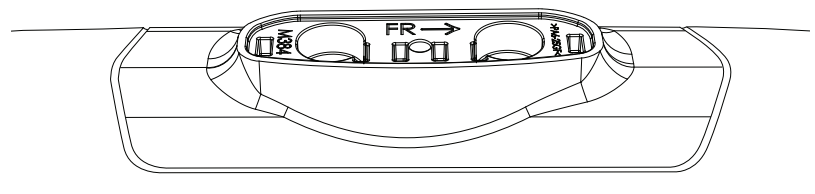



RCP19 Nissan X-Trail Heavy Duty Removable 2 Bar System

7

For each Pad:

Place two M6 x 27mm Security Bolts with a M6 Spring Washer and M6 x 16mm Flat Washer into the holes as shown.

For the Leg and Crossbar:

Place a M6 x 27mm Security Bolt with a M6 Spring Washer and M6 x 12.5mm Flat Washer into each Leg hole.

Check the Crossbar over hang is equal on both sides, re-adjust if required.

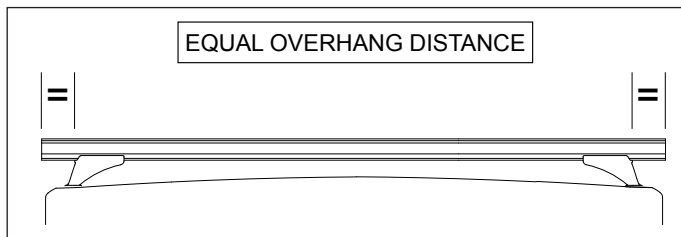

When the roof crossbars and legs are removed the roof pads can be covered for protection with the Mounting Pad Cover Plates

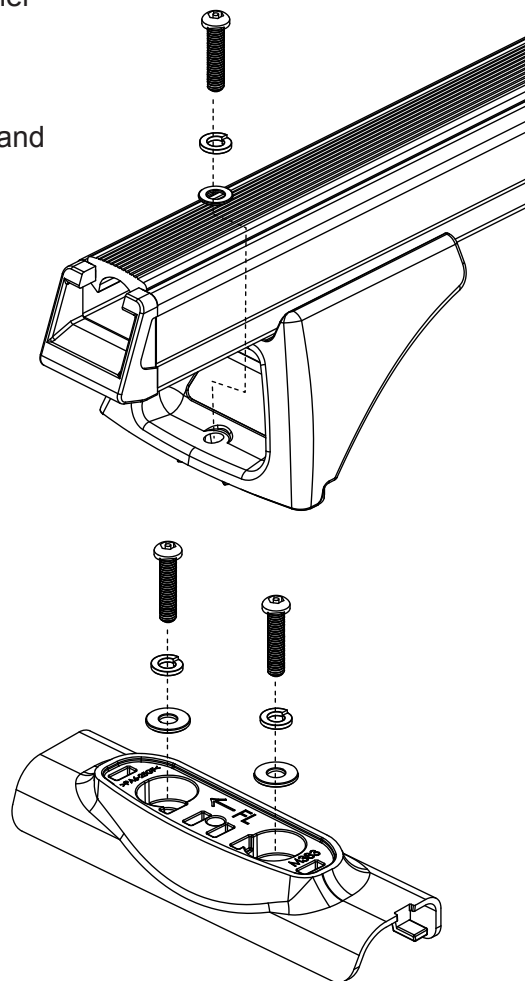
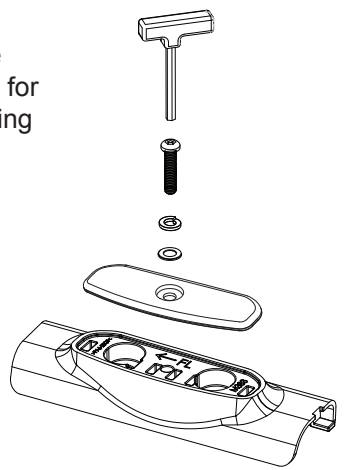

8

When front and rear Crossbars are in required position, Tighten the M10 x 20mm hex bolt on the underside to 5 Nm. **DO NOT OVER TIGHTEN.**

Fasten the Leg to the Pad to a torque of 4Nm. Repeat the process for the rear Crossbar Assembly. **DO NOT OVER TIGHTEN.**

Store the Security Allen Key in a suitable place.

